

BT L 2000, L 2300, L 2000-U and L 2300-U Hydraulic Unit

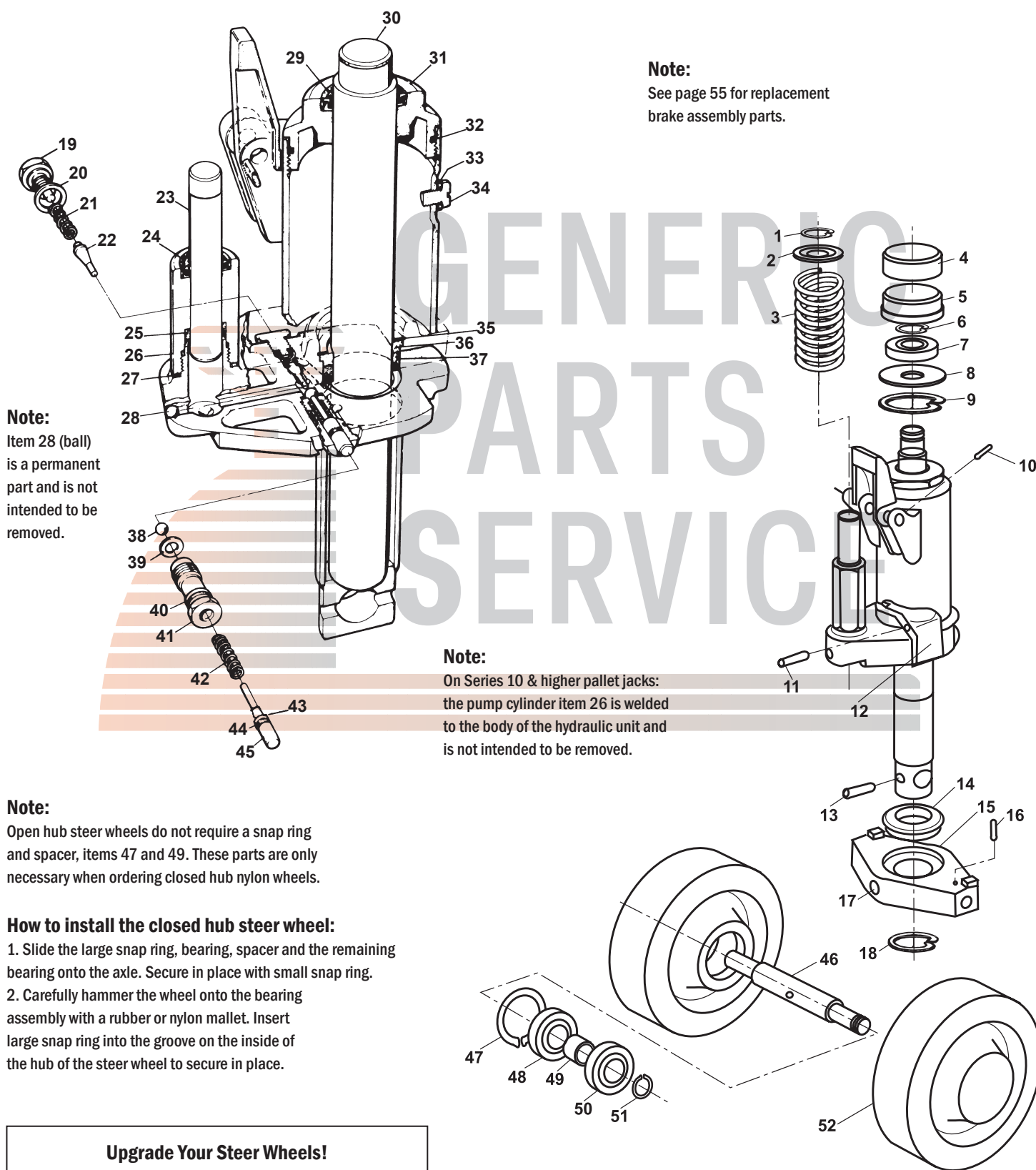

Note:
 See page 55 for replacement brake assembly parts.

Note:
 Item 28 (ball) is a permanent part and is not intended to be removed.

Note:
 On Series 10 & higher pallet jacks: the pump cylinder item 26 is welded to the body of the hydraulic unit and is not intended to be removed.

Note:
 Open hub steer wheels do not require a snap ring and spacer, items 47 and 49. These parts are only necessary when ordering closed hub nylon wheels.

How to install the closed hub steer wheel:
 1. Slide the large snap ring, bearing, spacer and the remaining bearing onto the axle. Secure in place with small snap ring.
 2. Carefully hammer the wheel onto the bearing assembly with a rubber or nylon mallet. Insert large snap ring into the groove on the inside of the hub of the steer wheel to secure in place.

Upgrade Your Steer Wheels!
 Try Our Aluminum Hub/Ultra-Poly Tread Wheels

BT L 2000, L 2300, L 2000-U and L 2300-U Hydraulic Unit

| Item | Part No. | Description |
|------|------------|--------------------------------|
| 1 | 20043 | Snap Ring |
| 2 | 47450 | Washer |
| 3 | 65245 | Spring |
| 4 | 47997 | Insert |
| 5 | 47996 | Bearing Cap, Steel |
| | 164675 | Bearing Cap (Series 12), Nylon |
| 6 | 20041 | Snap Ring |
| 7 | 20018 | Bearing |
| 8 | 47995 | Washer |
| 9 | 20076 | Snap Ring |
| 10 | 20071 | Roll Pin |
| 11 | A B 20104 | Roll Pin |
| 12 | 47070 | Release Lever |
| 13 | 20868 | Roll Pin |
| 14 | 22052 | Traverse Bearing |
| 15 | 47092 | Traverse |
| 16 | 20001 | Roll Pin |
| 17 | 20026 | Grease Fitting (Threaded) |
| 18 | 20011 | Snap Ring |
| 19 | 43713 | Screw Plug |
| 20 | ABCF 37218 | Washer |
| 21 | A B 39106 | Spring |
| 22 | A B 47049 | Valve |
| 23 | 47043 | Piston |
| | 130168 | Piston (Series 10, 11 and 12) |
| 24 | ABCD 21060 | Scraper |
| 25 | ABCD 21065 | U-Cup (Series 10) |
| | ABCD 22033 | U-Cup |
| 26 | 47042 | Pump Cylinder |
| 27 | ABCD 47044 | Washer |
| 28 | N/A | Ball (Do Not Remove) |
| 29 | ABCE 20066 | Scraper |
| 30 | 47985 | Ram |
| 31 | 47037 | Top Nut |
| 32 | ABCE 21024 | O-Ring |
| 33 | ABCE 21742 | Washer |
| 34 | 20345 | Filler Plug |
| 35 | A B 20101 | Snap Ring |
| 36 | A B 47039 | Bushing |
| 37 | ABCE 22034 | U-Cup |
| 38 | ABCF 20065 | Ball |
| 39 | ABCF 47050 | Washer |
| 40 | ABCF 22032 | O-Ring |
| 41 | A 129209 | Release Pin Guide |

| Item | Part No. | Description |
|--------|--------------|-----------------------------------------------------------------------------------------------------------------------------------------------|
| 42 | A B 47071 | Spring |
| 43 | A B 49513 | Spring Guide |
| 44 | ABCF 22318 | Scraper |
| 45 | A B 47051 | Release Pin |
| 46 | 47144 | Steer Wheel Axle |
| 47 | 20923 | Snap Ring |
| 48 | 22123 | Bearing |
| 49 | 47149 | Spacer |
| 50 | 20332 | Bearing |
| 51 | 20019 | Snap Ring |
| 52 | 102665-A | Steer Wheel Assembly, Nylon W/ Bearings, Closed Hub |
| | 160422-HD | Steer Wheel Assembly, Red Ultra-Poly On Aluminum Hub W/ Bearings |
| | 160422-ST | Steer Wheel Assembly, Black Poly On Nylon Hub W/ Bearings |
| | 160421 | Steer Wheel Assembly, Nylon W/ Bearings |
| | 160433 | Steer Wheel Assembly, Steel W/ Bearings |
| | GWK-BTL-CK | Complete Wheel Kit, 3-1/4" Diameter, (2) Load Roller Assembly, (2) Steer Wheel Assembly W/ Bearings, Axles and Fasteners, Open Hub |
| | GWK-BTU-CK | Complete Wheel Kit, 2.9" Diameter (2) Ultra-Poly Load Roller Assemblies (70D), (2) Poly Steer Wheel Assemblies, W/Bearings, Axles & Fasteners |
| 53 | 65245-KIT | Return Spring Kit (Includes Items 1, 2 and 3) |
| KITS A | 129883-SUPER | Super Seal Kit |
| KITS B | 129883 | Complete Seal Kit |
| KITS C | 129883-SLIM | Slim Seal Kit |
| KITS D | 130784 | Pump Cylinder Kit |
| KITS D | 22306 | Pump Cylinder Kit |
| KITS E | 129881 | Lift Cylinder Kit |
| KITS F | 129882 | Valve Packing Kit |
| | HU BTL 2000 | Rebuilt Hydraulic Unit - Exchange |
| | BT 131866-AM | New After Market Hydraulic Unit |

