

Bishamon BS-55 Frame

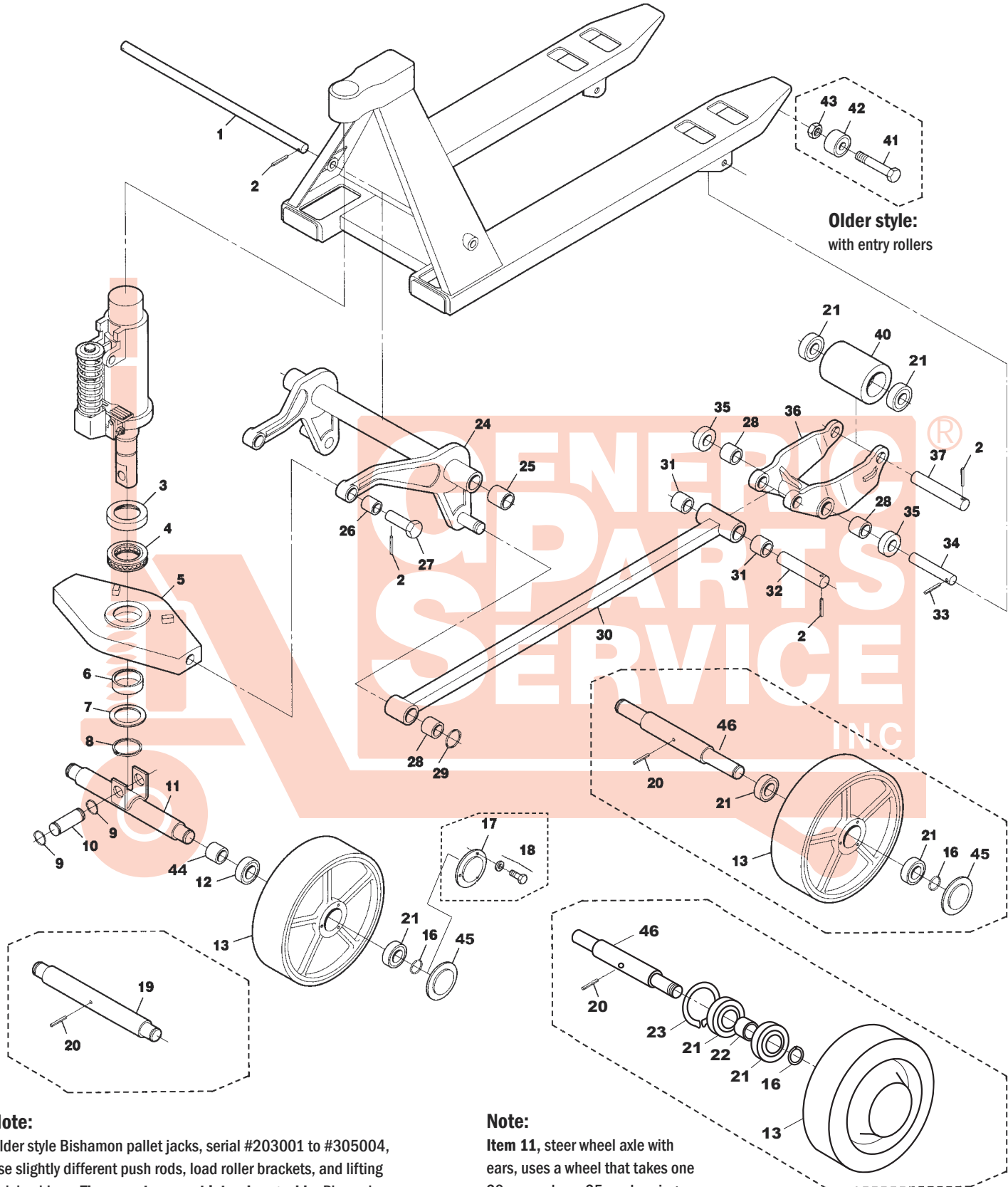

Older style:
with entry rollers

Note:

Older style Bishamon pallet jacks, serial #203001 to #305004, use slightly different push rods, load roller brackets, and lifting link bushings. **These parts are not interchangeable.** Please be sure you know which jack you have before ordering parts. The easiest way to tell, besides the serial number, is older style jacks have entry rollers (item 42).

Note:

Item 11, steer wheel axle with ears, uses a wheel that takes one 20mm and one 25mm bearing.
Item 19, steer wheel axle with no ears, uses a wheel that takes one 20mm and one 25mm bearing.
Item 46, steer wheel axle, uses a wheel that takes two 20mm bearings.

Bishamon BS-55 Frame

Item	Part No.	Description	List Price
1	12007244	Lifting Link Shaft, 27" Wide Jack	\$20.00
2	90980530	Roll Pin	\$0.50
3	12003683	Bearing Cover	\$5.00
4	81251109	Traverse Bearing	\$18.00
5	12013674	Traverse	Special Order
6	81940442	Bushing	\$5.00
7	12003693	Washer	\$3.00
8	80845025	Snap Ring	\$0.50
9	80848009	Snap Ring	\$1.25
10	12103784	Pin	\$12.00
11	02103774	Steer Wheel Axle, Oldest Style	*\$59.00
12	6005 ZZ	Bearing, 25mm ID	*\$1.00
	81036205	Bearing (OEM Steer Wheel Only)	\$5.00
13	12061733-A1-HD	Steer Wheel Assembly, Red Ultra Poly On Aluminum Hub W/ (1) 20 mm and (1) 25 mm Bearing	\$55.00
	12061733-A1-ST	Steer Wheel Assembly, Black Poly On Nylon Hub W/ (1) 20 mm and (1) 25 mm Bearing	\$38.00
	12061733-S1	Steer Wheel Assembly, Steel W/ (1) 20 mm and (1) 25 mm Bearing	\$59.00
	12061733-A2-HD	Steer Wheel Assembly, Red Ultra Poly On Aluminum Hub W/ (2) 20 mm Bearings	\$55.00
	12061733-A2-ST	Steer Wheel Assembly, Black Poly On Nylon Hub W/ (2) 20 mm Bearings	\$38.00
	85001753-A	Steer Wheel Assembly, Nylon, Newer Style Closed Hub W/ (2) 20 mm Bearings	\$36.00
16	80845011	Snap Ring	\$0.50
17	12003753	Hub Cap (Not Used On Aluminum Hub)	\$10.00
18	90890512	Bolt and Washer (OEM Steer Wheel Only)	\$1.00
19	12003710-1	Axle, Older Style	\$18.60
20	90980845	Roll Pin	\$1.00
21	81046204	Bearing, 20 mm ID	\$5.00
	81036004	Bearing, 20 mm ID, (For OEM 2-3/4" Load Roller Only)	\$5.00
	81026304	Bearing (For OEM Steer Wheel Only)	\$5.00
22	52103690	Sleeve	\$3.00
23	80846026	Snap Ring	\$1.00

Item	Part No.	Description	List Price
24	02108204	Lifting Link, 27" Wide Jack	Special Order
25	81920263	Bushing, 20-1/2" Wide Jack	\$5.00
	81922283	Bushing, 27" Wide Jack (Newer Style)	\$10.00
	81920283	Bushing, 27" Wide Jack	\$10.00
26	81916201	Bushing	\$3.00
27	12003703	Shoulder Pin	\$10.00
28	81920243	Bushing	\$2.75
29	80847015	Snap Ring	\$1.00
30	02108264	Push Rod, 48" Forks (Newer Style)	\$79.00
	02016263	Push Rod, 48" Forks (Older Style Serial #203001 to # 305004)	Special Order
31	81920241	Bushing	\$5.00
32	12003293	Push Rod Axle	\$12.00
33	90980540	Roll Pin	\$0.50
34	12003313	Pivot Axle	\$8.50
35	12103433	Exit Roller	\$8.00
36	02103304	Load Roller Bracket (Newer Style)	\$39.00
	02003304	Load Roller Bracket (Older Style) Replace W/ 02103304	Not Available
37	12003333	Load Roller Axle	\$8.00
40	85007098-A-D	Load Roller Assembly, 2-3/4" Dia., Black Ultra Poly On Steel Hub W/ Bearings	\$32.00
	85007098-N-A	Load Roller Assembly, 2-3/4" Dia., Nylon W/ Bearings	\$30.00
	12061323-A-D	Load Roller Assembly, 3-1/4" Dia., Red Ultra Poly On Aluminum Hub W/ Bearings	\$38.00
	12061323-A	Load Roller Assembly, 3-1/4" Dia., Black Ultra Poly On Steel Hub W/ Bearings	\$32.00
	12061323-N-A	Load Roller Assembly, 3-1/4" Dia., Nylon W/ Bearings	\$30.00
41	52008153	Bolt	\$1.00
42	52008143	Entry Roller	\$5.00
43	90931508	Adjusting Nut	\$0.50
44	BU 25mm	Spacer	\$3.00
45	BU 47mm HC	Hub Cap	\$5.00
46	12003710-2	Axle, Newer Style	\$20.00