

Rol-Lift Series E Frame

Including Series E 2.9 (Lowered Height) Jacks

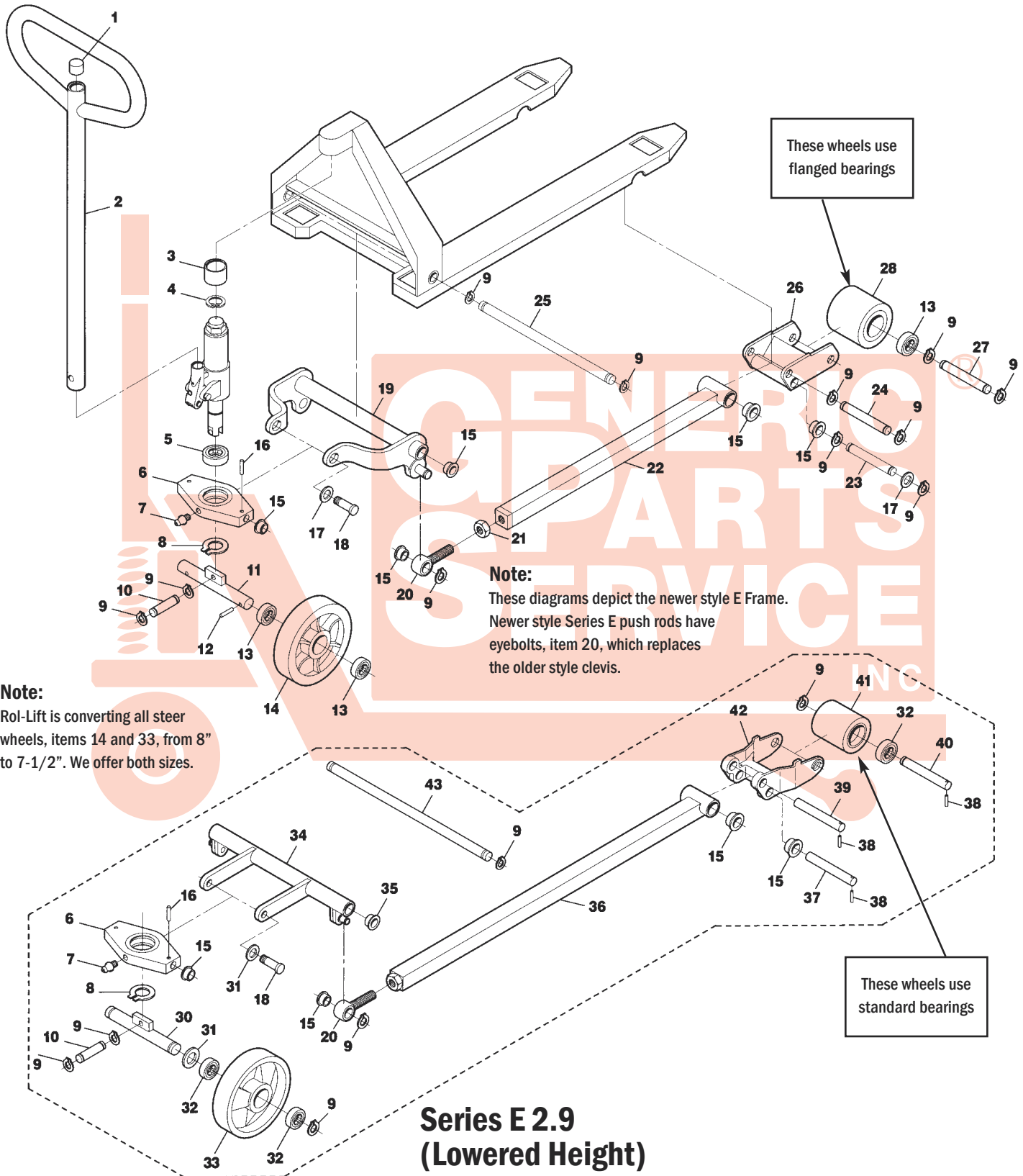

Note:
 Rol-Lift is converting all steer wheels, items 14 and 33, from 8" to 7-1/2". We offer both sizes.

Note:
 These diagrams depict the newer style E Frame. Newer style Series E push rods have eyebolts, item 20, which replaces the older style clevis.

Series E 2.9 (Lowered Height)

RoL-Lift Series E Frame

Including Series E 2.9 (Lowered Height) Jacks

Item	Part No.	Description	List Price	Item	Part No.	Description	List Price
1	3-27137	Handle Plug	\$5.00	28	3-91003-A-D	Load Roller Assembly, Red Ultra Poly On Aluminum Hub W/ 4 Flanged Bearings, 6500# Capacity	\$58.00
2	7-60017	Handle Frame (Foot Control Models)	Not Available		RL-31-D	Load Roller Assembly, Red Ultra Poly On Aluminum Hub W/ Bearings, 3-1/4" Dia., Flanged Bearings	\$50.00
3	4-00103	Bushing (Welded Into Frame)	\$18.00		RL-31-N	Load Roller Assembly, Nylon W/ Flanged Bearings, 3-1/4" Dia.	\$40.00
4	3-11005	Snap Ring	\$1.00		RL-31-S	Load Roller Assembly, Steel W/ Flanged Bearings, 3-1/4" Dia.	\$60.00
5	3-70001	Traverse Bearing	\$14.00		RL-31-3	Load Roller Assembly, Red Ultra Poly On Aluminum Hub W/ Bearings, 3" Dia., Flanged Bearings	\$38.00
6	4-00058	Traverse	Not Available		WHL-5010-EPTUM	Load Roller Assembly, Nylon W/ Flanged Bearings, 3" Dia.	\$30.00
7	1-20002	Grease Fitting	\$1.00		RL-31-S-3	Load Roller Assembly, Steel W/ Flanged Bearings, 3" Dia.	\$56.00
8	3-11002	Snap Ring	\$1.00	30	KIT-5090-TPTUM	Steer Wheel Axle Assembly	\$18.00
9	3-11003	Snap Ring	\$0.50	31	3-10203	Washer	\$0.50
10	KIT-5144-TPTUM	Pin with Snap Rings	\$10.00	32	BRG-5000-TPTUM	Bearing	\$5.00
11	7-60021	Steer Wheel Axle	\$25.00	33	WHL-5012-TPTUM	Steer Wheel Assembly, Poly On Nylon Hub W/ Bearings, 7-1/2" Dia., Flanged Bearings	\$48.00
12	3-25801-06	Roll Pin	\$0.50	34	KIT-5099-EPTFM	Lifting Link, 27" Wide Jack	\$49.00
13	3-70002	Bearing (Flanged)	\$10.00	35	BSH-5001-TPTUM	Bushing	\$5.00
	T-22-WA	Bearing (Wet Application)	\$20.00	36	PHR-5004-TPTUM	Push Rod, 48" Forks	\$38.00
14	RL-32-HD	Steer Wheel Assembly, Red Ultra Poly On Aluminum Hub W/ Bearings, 8" Dia., Flanged Bearings	\$60.00	37	PNB-5025-TPTUM	Pivot Axle, 7" Wide Forks	\$10.00
	RL-32-ST	Steer Wheel Assembly, Poly On Nylon Hub W/ Bearings, 8" Dia., Flanged Bearings	\$55.00		PNB-5020-TPTUM	Pivot Axle, 6" Wide Forks	\$10.00
	RL-32-N	Steer Wheel Assembly, Nylon W/ Flanged Bearings, 8" Dia.	\$36.00	38	3-25801-06	Roll Pin	\$0.50
	RL-32-S	Steer Wheel Assembly, Steel W/ Flanged Bearings, 8" Dia.	\$59.00	39	PNB-5019-TPTUM	Push Rod Axle	\$10.00
15	3-27020	Bushing, 3/4", Nylon	\$1.00	40	KIT-5136-TPTUM	Load Roller Axle	\$10.00
16	3-25800-07	Roll Pin	\$0.50	41	WHL-5013-TPTUM-D	Load Roller Assembly, Red Ultra Poly On Aluminum Hub W/ Bearings, 3" Dia., Standard Bearings	\$38.00
17	3-27021	Washer	\$0.50		WHL-5013-TPTUM	Load Roller Assembly, Black Ultra Poly On Steel Hub W/ Bearings, 3" Dia., Standard Bearings	\$32.00
18	4-00107	Shoulder Pin	\$10.00		WHL-5010-EPTUM	Load Roller Assembly, Nylon W/ Bearings, 3" Dia., Standard Bearings	\$30.00
19	8-60015-01	Lifting Link, 21" Wide Jack	Not Available		WHL-5013-TPTUM-S	Load Roller Assembly, Steel W/ Bearings, 3" Dia., Standard Bearings	\$45.00
	KIT-5040-TPTUM	Lifting Link, 27" Wide Jack	Not Available	42	BKT-5004-TPTUM	Load Roller Bracket	Not Available
20	PHR-5010-TPTUM	Eye Bolt	\$12.00	43	KIT-5127-EPTUM	Lifting Link Shaft, 27" Wide Jack	\$18.00
21	3-50002	Nut	\$1.00				
22	7-10041-03	Push Rod, 48" Forks	\$38.00				
23	4-61036	Pivot Axle, 7" Wide Forks	\$10.00				
	4-00102	Pivot Axle, 6" Wide Forks	\$10.00				
24	4-00100	Push Rod Axle, 7" Wide Forks	\$10.00				
	4-00101	Push Rod Axle, 6" Wide Forks	\$10.00				
25	4-00106-01	Lifting Link Shaft, 27" Wide Jack	\$18.00				
26	4-00089-HD	Load Roller Bracket, 6" Wide Forks (Heavy Duty)	Not Available				
27	4-00100	Load Roller Axle	\$10.00				

*Non-discounting item

Prices subject to change without notice. All manufacturers' names, part numbers and descriptions are used for reference purposes only. We do not imply that any parts are the products of a particular manufacturer. Copyright © 2008 by GPS, Inc. All rights reserved.