

Rol-Lift Series E Frame

Including Series E 2.9 (Lowered Height) Jacks

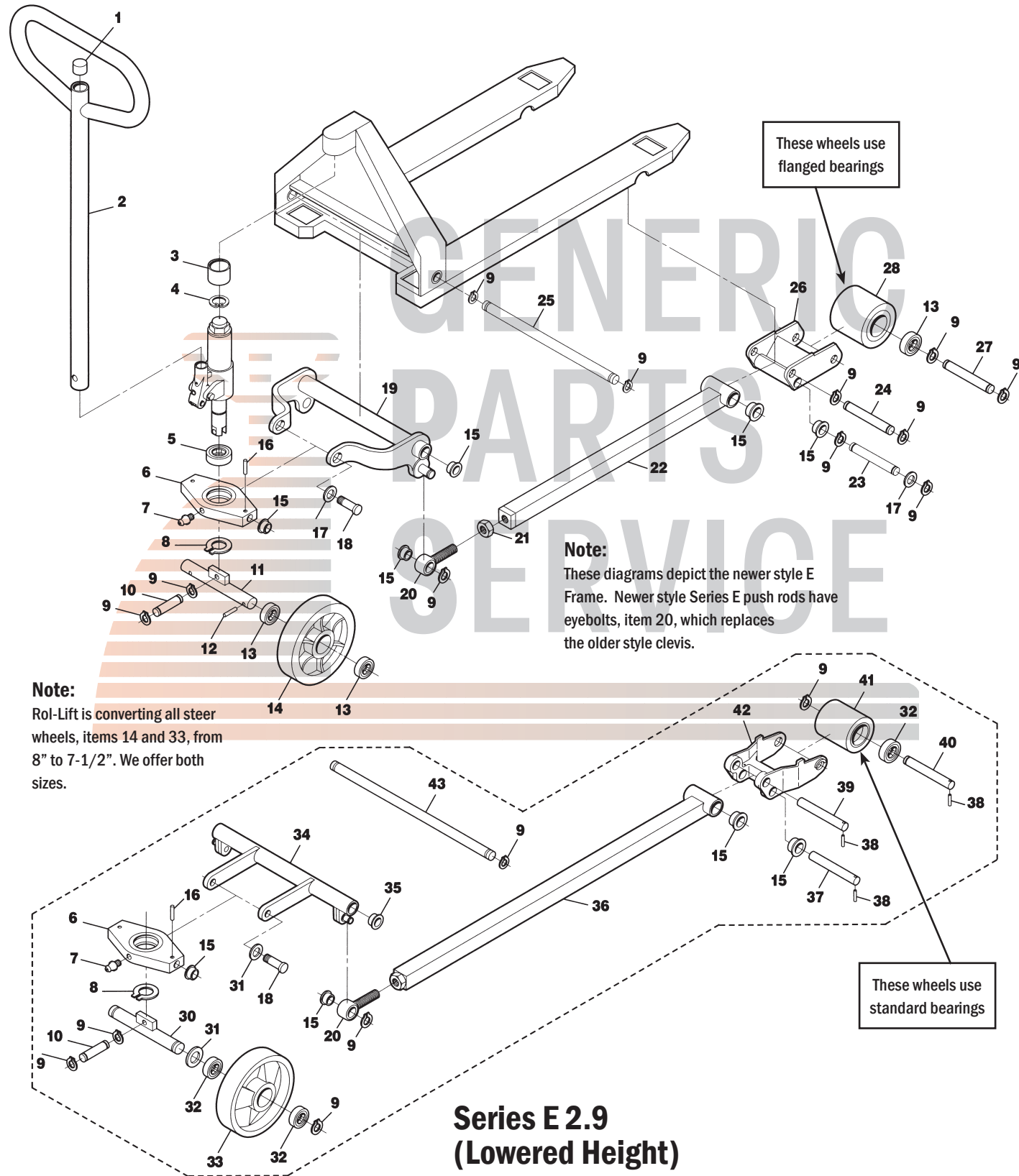

Series E 2.9 (Lowered Height)

Note:

Rol-Lift is converting all steer wheels, items 14 and 33, from 8" to 7-1/2". We offer both sizes.

Note:

These diagrams depict the newer style E Frame. Newer style Series E push rods have eyebolts, item 20, which replaces the older style clevis.

Rol-Lift Series E Frame

Including Series E 2.9 (Lowered Height) Jacks

Item	Part No.	Description
1	3-27137	Handle Plug
2	7-60017	Handle Frame (Foot Control Models)
3	4-00103	Bushing (Welded Into Frame)
4	3-11005	Snap Ring
5	3-70001	Traverse Bearing
6	4-00058	Traverse
7	1-20002	Grease Fitting
8	3-11002	Snap Ring
9	3-11003	Snap Ring
10	KIT-5144-TPTUM	Pin with Snap Rings
11	7-60021	Steer Wheel Axle
12	3-25801-06	Roll Pin
13	3-70002	Bearing (Flanged)
	T-22-WA	Bearing (Wet Application)
14	RL-32-HD	Steer Wheel Assembly, Red Ultra-Poly On Aluminum Hub W/ Bearings, 8" Diameter, Flanged Bearings
	RL-32-N	Steer Wheel Assembly, Nylon W/ Flanged Bearings, 8" Diameter
	RL-32-S	Steer Wheel Assembly, Steel W/ Flanged Bearings, 8" Diameter
15	3-27020	Bushing, 3/4", Nylon
16	3-25800-07	Roll Pin
17	3-27021	Washer
18	4-00107	Shoulder Pin
19	8-60015-01	Lifting Link, 21" Wide Jack
	KIT-5040-TPTUM	Lifting Link, 27" Wide Jack
20	PHR-5010-TPTUM	Eye Bolt
21	3-50002	Nut
22	7-10041-03	Push Rod, 48" Forks
23	4-61036	Pivot Axle, 7" Wide Forks
	4-00102	Pivot Axle, 6" Wide Forks
24	4-00100	Push Rod Axle, 7" Wide Forks
	4-00101	Push Rod Axle, 6" Wide Forks
25	4-00106-01	Lifting Link Shaft, 27" Wide Jack
26	7-61005	Load Roller Bracket, 7" Wide Forks
	4-00089-HD	Load Roller Bracket, 6" Wide Forks (Heavy Duty)
27	4-00100	Load Roller Axle

Item	Part No.	Description
28	3-91003-A-D	Load Roller Assembly, Red Ultra-Poly On Aluminum Hub W/ 4 Flanged Bearings, 6500# Capacity
	RL-31	Load Roller Assembly, Black Ultra-Poly On Steel Hub W/ Bearings, 3-1/4" Diameter, Flanged Bearings
	RL-31-N	Load Roller Assembly, Nylon W/ Flanged Bearings, 3-1/4" Diameter
	RL-31-S	Load Roller Assembly, Steel W/ Flanged Bearings, 3-1/4" Diameter
	RL-31-3	Load Roller Assembly, Red Ultra-Poly On Aluminum Hub W/ Bearings, 3" Diameter, Flanged Bearings
	RL-31-S-3	Load Roller Assembly, Steel W/ Flanged Bearings, 3" Diameter
30	KIT-5090-TPTUM	Steer Wheel Axle Assembly
31	3-10203	Washer
32	BRG-5000-TPTUM	Bearing
33	WHL-5012-TPTUM	Steer Wheel Assembly, Poly On Nylon Hub W/ Bearings, 7-1/2" Diameter, Flanged Bearings
34	KIT-5099-EPTFM	Lifting Link, 27" Wide Jack
35	BSH-5001-TPTUM	Bushing
36	PHR-5004-TPTUM	Push Rod, 48" Forks
37	PNB-5025-TPTUM	Pivot Axle, 7" Wide Forks
	PNB-5020-TPTUM	Pivot Axle, 6" Wide Forks
38	3-25801-06	Roll Pin
39	PNB-5019-TPTUM	Push Rod Axle
40	KIT-5136-TPTUM	Load Roller Axle
41	WHL-5013-TPTUM-D	Load Roller Assembly, Red Ultra-Poly On Aluminum Hub W/ Bearings, 3" Diameter, Standard Bearings
	WHL-5013-TPTUM	Load Roller Assembly, Black Ultra-Poly On Steel Hub W/ Bearings, 3" Diameter, Standard Bearings
	WHL-5010-EPTUM	Load Roller Assembly, Nylon W/ Bearings, 3" Diameter, Standard Bearings
	WHL-5013-TPTUM-S	Load Roller Assembly, Steel W/ Bearings, 3" Diameter, Standard Bearings
42	BKT-5004-TPTUM	Load Roller Bracket
43	KIT-5127-EPTUM	Lifting Link Shaft, 27" Wide Jack